

CWDA 2011 Symposium:

Strengthening Families ▪ Creating Economic Security ▪ Building Healthy Communities



October 5–6, 2011
Sacramento Convention Center
Sacramento, California 95814

October 2011

Welcome to the **CWDA 2011 Symposium: *Strengthening Families, Creating Economic Security, Building Healthy Communities***. This is the third symposium in our series on poverty hosted by the County Welfare Directors Association of California.

Following up on the insightful 2009 and 2010 symposiums, we continue striving to strengthen efforts across California to address the growing impact of poverty, and to recognize the lives of those who struggle to make ends meet everyday across our state. This year's symposium seeks to explore on-the-ground strategies for strengthening families, including bringing economic security to their lives and building healthy communities around them.

The impacts and effects of poverty are now well-known and well-documented. The Great Recession and record unemployment rates in recent years have given new attention to the struggles of children, families and seniors plunged in poverty. California's poverty rate rose in 2009 for the third straight year to 15.3 percent, with Latinos and African Americans experiencing much higher poverty rates than other racial groups. Alarming, California's childhood poverty rate now sits at 20 percent.

Melissa Harris-Perry, professor of political science at Tulane University, author of *Sister Citizen: Shame, Stereotypes, and Black Women in America*, and frequent commentator and guest host on MSNBC, will discuss the role of race, poverty and insecurity in today's political agenda. **Dr. Tony Iton** of The California Endowment will share his experience and interest in serving disadvantaged populations and the contributions of race, class, wealth, education, geography, and employment to health status.

We will hear from **David Bradley** with the National Community Action Foundation on the mood in Washington, D.C. and how it's impacting programs for low-income individuals and families. **Maurice Lim Miller**, founder of the Family Independence Initiative, will discuss how we can help communities lead initiatives that result in greater self-sufficiency.

We will also learn about efforts in some of our communities to turn the tide on poverty: a charter school in South Los Angeles working to eliminate the achievement gap; improved collaborations among community-based organizations and social service agencies; innovative support for foster youth transitioning into adulthood; and how we can better work with the health community to integrate medical, social and mental health services.

As human service professionals, advocates and policymakers, it is imperative that we keep a spotlight on poverty and press forward in our commitment to its eradication. You are a valued partner in this effort, and we thank you for joining us in this ongoing endeavor.



Cathi Grams
Symposium Planning Committee Chair
Director, Butte County
Department of Employment and Social Services



Elliott Robinson
CWDA President
Director, Monterey County
Department of Social and Employment Services

SCHEDULE AT A GLANCE

WEDNESDAY | OCTOBER 5, 2011

8:30 AM — 10:00 AM	Registration	3 rd Floor East Lobby
10:00 AM — 11:00 AM	Welcome Remarks & Opening General Session <ul style="list-style-type: none"> Welcome: Elliott Robinson, CWDA President Featured Speakers: Secretary Diana Dooley, California Health & Human Services Agency Senator Carol Liu, California 21st Senate District 	Ballroom 306/307
11:00 AM — 12:00 PM	General Session <ul style="list-style-type: none"> Featured Speaker: David Bradley, Executive Director, National Community Action Foundation 	Ballroom 306/307
12:00 PM — 1:15 PM	Hosted Lunch	Ballroom 314/315
1:15 PM — 2:15 PM	General Session <ul style="list-style-type: none"> Featured Speaker: Maurice Lim Miller, CEO/President, Family Independence Initiative 	Ballroom 306/307
2:15 PM — 2:30 PM	Break	3 rd Floor East Lobby
2:30 PM — 4:00 PM	Mini-Plenary Sessions <ul style="list-style-type: none"> Synergy Charter Academy – Working Together to Improve Academics, Reduce Poverty Social Services and Community Action Agencies – Building Partnerships that Result in Greater Economic Security Helping Families Become Financially Empowered Success Stories and Collaboration in Nutrition Education 	Ballroom 308 Ballroom 309/310 Ballroom 311/312 Ballroom 313
4:00 PM — 4:15 PM	Break	3 rd Floor East Lobby
4:15 PM — 5:45 PM	Sponsors' Sessions <ul style="list-style-type: none"> Accenture – Skills to Succeed Corporate Citizenship Program HP Enterprise Services – Pushing Self-Service Boundaries to Achieve Instant Access to Benefits InTelegy Corporation – Creating Greater Access to Benefits Northwoods – Utilizing Technology to Improve Customer Service 	Ballroom 308 Ballroom 309/310 Ballroom 311/312 Ballroom 313
6:00 PM — 8:00 PM	Reception	Sheraton Grand Hotel Gardenia Room

THURSDAY | OCTOBER 6, 2011

7:30 AM — 8:30 AM	Hosted Breakfast Buffet	Ballroom 314/315
8:30 AM — 9:00 AM	General Session (Part 1) <ul style="list-style-type: none"> Welcome: Frank Mecca, CWDA Executive Director Featured Speakers: Herb Schultz, HHS Region IX Director Will Lightbourne, Director, California Department of Social Services 	Ballroom 306/307/308
9:00 AM — 10:15 AM	General Session (Part 2) <ul style="list-style-type: none"> Featured Speaker: Dr. Tony Iton, Senior Vice President for Healthy Communities, The California Endowment 	Ballroom 306/307/308
10:15 AM — 10:30 AM	Break	3 rd Floor East Lobby
10:30 AM — 12:00 PM	Mini-Plenary Sessions <ul style="list-style-type: none"> Winning Wage Justice Looking Beyond the Basic Symptoms – Integrating Medical, Social and Mental Health Services Into Adulthood – Supporting Transitional Foster Youth into the Next Stage of Life 	Ballroom 309/310 Ballroom 311/312 Ballroom 313
12:00 PM — 1:00 PM	Hosted Lunch	Ballroom 314/315
1:00 PM — 2:30 PM	Mini-Plenary Sessions <ul style="list-style-type: none"> Strengthening Families Framework – Building Strong Communities in Support of Families SparkPoint Centers – One-Stop Shopping for Families Preparing for the Growing Aging Population 	Ballroom 309/310 Ballroom 311/312 Ballroom 313
2:30 PM — 2:45 PM	Break	3 rd Floor East Lobby
2:45 PM — 4:00 PM	General Session <ul style="list-style-type: none"> Featured Speaker: Melissa Harris-Perry, Professor of Political Science, Tulane University, Author of <i>Sister Citizen: Shame, Stereotypes, and Black Women in America</i> 	Ballroom 306/307/308
4:00 PM — 4:30 PM	General Session: Wrap-Up and Closing	Ballroom 306/307/308

KEYNOTE SPEAKERS



David Bradley
Executive Director, National
Community Action Foundation

David Bradley is Executive Director of National Community Action Foundation, which he helped found in 1981. The foundation is a private, nonprofit advocacy organization that interacts with Congress, the executive branch, state and local governments, and local agencies on behalf of a variety of low-income programs. For nearly three decades, Bradley has been recognized as one of Washington's leading advocates for low-income programs. He is the principle author of the Community Services Block Grant, the three-quarter of a billion dollar program that provides the core funding to the nation's community action agency network. He helped found and fund CAP LAW, which provides a legal support system to this anti-poverty network and is widely credited with increasing the effectiveness of federal, state and local partnerships in the Community Services Block Grant network. He has also served as senior executive fellow at the Harvard University John F. Kennedy School of Government, and congressional liaison at the Small Business Administration as part of President Jimmy Carter's Administration. Bradley has a bachelor's degree and master's degree from George Washington University.



Maurice Lim Miller
Founder/CEO, Family
Independence Initiative

Maurice Lim Miller is the founder and CEO of the Family Independence Initiative, an Alameda County-based pilot project that seeks to break the cycle of poverty by building the capacities of low-income families to create their own pathways to self-sufficiency. Families enrolled in FII work together to set goals and are rewarded through a cash incentive program as they make progress toward realizing them. He also sits on the board of directors of The California Endowment and the Hitachi Foundation. Prior to founding FII, Miller was the executive director of Asian Neighborhood Design, a multi-service community development agency in San Francisco. Miller is also involved with the Corporation for Enterprise Development, a national organization focused on building economic assets for poor communities, and Public Private Ventures, a national research organization focused on youth and workforce development issues. He has received notable honors, including the Asian Pacific Heritage Month's *Local Hero of the Year Award*, Eureka Leadership Fellow, and Gerbode Foundation Fellow.



**Dr. Tony Iton, M.D., J.D.,
M.P.H.,**
Senior Vice President for Healthy
Communities, The California
Endowment

Dr. Tony Iton is Senior Vice President for Healthy Communities with The California Endowment, a private, statewide health foundation whose mission is to expand access to affordable, quality health care for underserved individuals and communities, and to promote fundamental improvements in the health status of all Californians. Prior to that, Dr. Iton served for seven years as the Alameda County Public Health Department director and health officer. Dr. Iton's primary interest is the health of disadvantaged populations and the contributions of race, class, wealth, education, geography, and employment to health status. Dr. Iton received his medical degree at Johns Hopkins Medical School and trained in internal medicine and preventive medicine at New York Hospital, Yale University, and the University of California, Berkeley, and is board certified in both specialties. He has also received a law degree and a master's degree in public health from UC Berkeley. He has also worked at the Berkeley Community Law Center, the Consumers Union West Coast Regional Office, and the San Francisco Public Health Department.



Melissa Harris-Perry
Political Science Professor,
Tulane University

Melissa Harris-Perry is Professor of political science at Tulane University, where she is founding director of the Project on Gender, Race, and Politics in the South. She previously served on the faculties of the University of Chicago and Princeton University. Harris-Perry is author of the eagerly anticipated new book, *Sister Citizen: Shame, Stereotypes, and Black Women in America*. Her first book, *Barbershops, Bibles, and BET: Everyday Talk and Black Political Thought*, won the 2005 W. E. B. Du Bois Book Award from the National Conference of Black Political Scientists, and the 2005 Best Book Award from the Race and Ethnic Politics Section of the American Political Science Association. She is a regular commentator for many print and radio sources in the U.S. and abroad. Harris-Perry received her Bachelor of Arts in English from Wake Forest University, her doctorate in political science from Duke University, and an honorary doctorate from Meadville Lombard Theological School. She also studied theology at Union Theological Seminary in New York.

PROGRAM AGENDA

Wednesday, October 5, 2011

8:30 AM — 10:00 AM	Registration.....	3 rd Floor East Lobby
10:00 AM — 11:00 AM	Welcome Remarks & General Session..... ■ Welcome: ▪ Elliott Robinson , <i>President, County Welfare Directors Association of California</i> <i>Director, Monterey County Department of Social and Employment Services</i> ■ Featured Speakers: ▪ Secretary Diana Dooley , <i>California Health and Human Services Agency</i> ▪ Senator Carol Liu , <i>California 21st Senate District</i>	Ballroom 306/307
11:00 AM — 12:00 PM	General Session..... ■ Featured Speaker: ▪ David Bradley , <i>Executive Director, National Community Action Foundation</i> The Changing Relationship Between the Federal Government and Human Services The nature of the federal government’s response to poverty and the relationship with human services programs is undergoing a dramatic change. Not since the 1960s or perhaps even the 1930s have the roles of government, private sector and individuals been as hotly debated as they are today. David Bradley will explain why we as a society find ourselves in this situation, what is likely to happen, and what we can do to impact the outcome.	Ballroom 306/307
12:00 PM — 1:15 PM	Hosted Lunch.....	Ballroom 314/315
1:15 PM — 2:15 PM	General Session..... ■ Featured Speaker: ▪ Maurice Lim Miller , <i>President/CEO, Family Independence Initiative</i> Recreating Conditions that Lead to Greater Self-Sufficiency We have reached a point in history where discourse has lost its civility, and populations are being pitted against one another. The safety net, institutions, and government are all being questioned. Is there opportunity out of all this adversity? Absolutely. America has a storied history of entire communities moving from poverty to self-sufficiency. This session will look at the elements that led to the self-determination and mutuality that created the “Black Wall Street” in Tulsa, led poor Irish to dominate some industries, and Cambodian refugees in the 1990s to own 80 percent of the donut shops in California. We will look at the Family Independence Initiative and how it recreates the conditions under which generation after generation of Americans has moved to self-sufficiency – and how we can help residents lead such initiatives.	Ballroom 306/307
2:15 PM — 2:30 PM	Break.....	3 rd Floor East Lobby
2:30 PM — 4:00 PM	Mini-Plenary Sessions ■ Synergy Charter Academy — Working Together to Improve Academics, Reduce Poverty..... Eliminating the achievement gap and creating educational equity for all students – those are far from easy goals but that’s what Meg and Randy Palisoc set out to do more than seven years ago when they opened their first Synergy Charter Academy campus in South Los Angeles. In this session, Meg and Randy Palisoc, co-founders of Synergy Academies, and several parents will discuss the academies’ focus on how working together as a community can help to reduce poverty and build capacity for both students and families. • Moderator: Alison Lehman , <i>Director, Nevada County Health and Human Services Agency</i> • Meg Palisoc , <i>Teacher/Co-Founder/Chief Executive Officer, Synergy Charter Academy</i> • Randy Palisoc , <i>Teacher/Co-Founder/Chief Achievement Officer, Synergy Charter Academy</i> • Armida Barrera , <i>Parent, Synergy Charter Academy</i> • Sandra DeLaTorre , <i>Parent, Synergy Charter Academy</i> ■ Social Services and Community Action Agencies – Building Partnerships that Result in Greater Economic Security..... For too long, well-intentioned community-based organizations and county social service departments have sought to address poverty by merely addressing the symptoms but have failed by not getting to the root of the issues facing families and individuals. Hear how county departments and local community action agencies are	Ballroom 308 Ballroom 309/310

shifting away from poverty maintenance by developing upstream strategies and investing in evidence-based programs to improve the lives of low-income people. This session will also highlight federal, state and private partnerships that have been used to create synergy regarding improved economic security for low-income communities.

- Moderator: **Charlene Reid**, *Director, Tehama County Department of Social Services*
- **Tim Reese**, *Executive Director, California/Nevada Community Action Partnership*
- **Jo Weber**, *Director, Sonoma County Human Services Department*
- **Oscar Chavez**, *Executive Director, Community Action Partnership of Sonoma County*
- **Barbara LaHaie**, *Assistant Director, Humboldt County Department of Health and Human Services*
- **Simone Taylor**, *Family Services Director, Redwood Community Action Agency*

■ **Helping Families Become Financially Empowered.....Ballroom 311/312**

Too much month at the end of the money. That’s the challenge many families in poverty face each month. Often they pay more for basic financial services – such as cashing paychecks or paying their bills – than other families. How do California families manage what little money they have, and not just get by but also handle emergencies and even plan for the future? Rourke O’Brien will provide an intimate snapshot of how CalWORKs recipients manage their financial lives, and José Cisneros will discuss how and why cities and counties can and should financially empower low-income residents.

- Moderator: **Gina Sessions**, *Acting Director, Santa Clara County Social Services Agency*
- **Rourke O’Brien**, *Research Fellow, New America Foundation*
- **José Cisneros**, *Treasurer, City and County of San Francisco*

■ **Success Stories and Collaboration in Nutrition Education.....Ballroom 313**

Local nutrition education programs for low-income families promote increased fruit and vegetable consumption and daily physical activity, essential keys to improving health. This session will highlight successful and innovative programs from around the state, discuss current issues in state and federal policy, and identify opportunities for collaboration and joint efforts. Current research findings indicate the percent of low-income adults who reached the minimum five-serving goal for fruit and vegetable consumption rose from a baseline of 24 percent in 1997 to 46 percent in 2007; and from 2000 to 2009, California’s overall ranking for fruit and vegetable consumption rose from 11th to 5th among all states. Participants will learn how local programs are contributing to these improvements, and discuss how we can build upon this progress to better help our clients improve nutrition in their homes

- Moderator: **Jason Britt**, *Human Services Director, Tulare County Health and Human Services Agency*
- **Terri Fields Hosler**, *Deputy Director, Shasta County Public Health*
- **Diane Woloshin**, *Nutrition Services Director, Alameda County Public Health Department*
- **Elaine Emery**, *Nutrition Services Program Manager, Stanislaus County Health Services Agency*

4:00 PM — 4:15 PM Break.....3rd Floor East Lobby

4:15 PM — 5:45 PM Sponsors’ Sessions

■ **Accenture – Skills to Succeed Corporate Citizenship Program.....Ballroom 308**

■ **HP Enterprise Services – Pushing Self-Service Boundaries to Achieve Instant Access to Benefits.....Ballroom 309/310**

■ **InTelegy Corporation – Creating Greater Access to Benefits.....Ballroom 311/312**

■ **Northwoods – Utilizing Technology to Improve Customer Service.....Ballroom 313**

6:00 PM — 8:00 PM Reception.....Sacramento Sheraton Grand, Gardenia Room

PROGRAM AGENDA

Thursday, October 6, 2011

7:30 AM — 8:30 AM Hosted Breakfast Buffet.....Ballroom 314/315

8:30 AM — 9:00 AM General Session (Part 1).....Ballroom 306/307/308

■ Welcome: **Frank Mecca**, *CWDA Executive Director*

■ Featured Speakers:

- **Herb Schultz**, *Region IX Director, U.S. Department of Health and Human Services*
- **Will Lightbourne**, *Director, California Department of Social Services*

9:00 AM — 10:15 AM	<p>General Session.....Ballroom 306/307/308</p> <ul style="list-style-type: none"> ■ Featured Speaker: <ul style="list-style-type: none"> ▪ Dr. Tony Iton, <i>Senior Vice President for Healthy Communities, The California Endowment</i> <p>The Nexus of Place and Health Overall, Californians' health has improved over the years. Unfortunately, health improvements have not been realized equally across population subgroups with stark inequities seen in life expectancy rates and early mortality rates driven by chronic diseases. And it's clear that where you live matters – a lot. Hear Dr. Tony Iton discuss the Alameda County Public Health Department's approach to building a healthier community through community capacity building, youth development, setting a local policy agenda, and building internal capacity. He'll also explain why building health communities and achieving health equity means fighting for social justice.</p>
10:15 AM — 10:30 AM	<p>Break.....3rd Floor East Lobby</p>
10:30 AM — 12:00 PM	<p>Mini-Plenary Sessions</p> <ul style="list-style-type: none"> ■ Winning Wage Justice.....Ballroom 309/310 Low-income workers struggle to make ends meet at today's wages, but many face an even greater challenge: wage theft. Millions of the working poor who are receiving less than the minimum wage are being forced to work "off the clock" or are being denied pay for overtime. The National Employment Law Project has researched and documented this phenomenon, and has proposed specific, concrete policies to battle abuses at the state and local levels. In this session, representatives from NELP will present their findings along with a menu of innovative policies to strengthen enforcement of minimum wage and overtime laws. <ul style="list-style-type: none"> • Moderator: Natalie Walter, <i>Department Administrator, San Luis Obispo County Social Services Department</i> • Rebecca Smith, <i>California Representative, National Employment Law Project</i> ■ Looking Beyond the Basic Symptoms – Integrating Medical, Social and Mental Health ServicesBallroom 311/312 A patient visits a clinic with what seem like routine health issues. But pushed to share a little more, and the doctor learns the adult patient experienced years of childhood trauma never addressed. Dr. Nadine Burke encounters such situations daily at her Bayview Child Health Center, a community-based satellite clinic of California Pacific Medical Center. It's her work there that led her to focus on serving a medically underserved area where issues of poverty and race present challenges to conventional healthcare and education. Working with the City and County of San Francisco and the Child Abuse Prevention Center, clinic, staff and others are working to improve health outcomes through innovative approaches that integrate medical, social and mental health services. <ul style="list-style-type: none"> • Moderator: Trent Rhorer, <i>Director, Human Services Agency of San Francisco</i> • Dr. Nadine J. Burke, <i>Founding Physician, California Pacific Medical Center Bayview Child Health Center</i> • Katie Albright, <i>Executive Director, San Francisco Child Abuse Prevention Center</i> ■ Into Adulthood – Supporting Transitional Foster Youth into the Next Stage of Life.....Ballroom 313 Given the increased number of at-risk older foster youth who reach adulthood without continued support, preparing youth to successfully transition to adulthood is a key challenge for counties and the state. This session will look at two successful programs working to address this challenge. In Alameda County, a public-private partnership led to the creation of the Fresh Start Cafe, staffed with youth who work for \$8 an hour, earn food handling certification, and course credit toward high school graduation. In Tuolumne County, the Housing and Opportunities for Emancipated Foster Youth (HOPE) House gives youth a place to learn about living independently while giving them a safe place to sleep. Both programs were winners of 2010 California State Association of Counties Challenge Awards. <ul style="list-style-type: none"> • Moderator: Lynn Nolte, <i>Program Manager, Chief Deputy Public Guardian, Tuolumne County Human Services Agency</i> • Michelle Clark, <i>Social Worker Supervisor, HOPE House Manager, Tuolumne County Human Services Agency</i> • Linda Downey, <i>Juvenile Unit Division Manager, Tuolumne County Probation Department</i> • Karen McGettigan, <i>Staff Services Analyst II, Tuolumne County Human Services Agency</i> • Michelle Love, <i>Assistant Agency Director, Children and Family Services, Alameda County Social Services Agency</i>
12:00 PM — 1:00 PM	<p>Hosted Lunch.....Ballroom 314/315</p>

1:00 PM — 2:30 PM

Mini-Plenary Sessions

■ **Strengthening Families Framework – Building Strong Communities in Support of Families**.....Ballroom 309/310

Strengthening Families is a research-based, cost-effective framework developed by the Center for the Study of Social Policy to increase family strengths, enhance child development and reduce child abuse and neglect. It focuses on building five “Protective Factors” for families in communities that also promote healthy outcomes. Utilized in more than 30 states, including several California counties, the framework has led to major shifts in policy, funding, and training to help programs working with children and families build Protective Factors with families. In this session, participants will learn the history and research behind this framework, and learn from the efforts and leadership of the director of the State of Illinois Child and Family Services. Participants will also hear about efforts underway in California and discuss strategies for local implementation.

- Moderator: **Michael Riley**, *Director, Orange County Social Services Agency*
- **Judy Langford**, *Associate Director/ Senior Fellow, Center for the Study of Social Policy*
- **Erwin “Mac” McEwen**, *Former Acting Director, Illinois Department of Children and Family Services*
- **Lee Ann Kelly**, *Assistant Chief, Office of Child Abuse Prevention, Children and Family Services Division, California Department of Social Services*

■ **SparkPoint Centers – One-Stop Shopping for Families**.....Ballroom 311/312

The United Way of the Bay Area and the Contra Costa County Employment and Human Services Department provide an overview of an exciting new model for helping families find “pathways out of poverty.” Two recently launched “SparkPoint Centers” in Contra Costa County implement a national model for providing “one-stop shopping” to help families achieve financial stability and self-sufficiency. United Way has partnered with the department and community nonprofits to offer a full range of services at each center, including job training, career development, credit counseling, matched savings and financial coaching, as well as access to higher education.

- Moderator: **Joe Valentine**, *Director, Contra Costa County Employment and Human Services Department*
- **Anne Wilson**, *Chief Executive Officer, United Way of the Bay Area*
- **Tse Ming Tam**, *Vice President of Community Investment, United Way of the Bay Area*
- **Paul Buddenhagen**, *Administrator, One-Stop Career Centers and Service Integration Program, Contra Costa County Employment and Human Services Department*

■ **Preparing for the Growing Aging Population**.....Ballroom 313

By 2030, more than 70 million Americans – twice the number in 2000 – will be 65 and over. How can counties and community agencies best respond to changing demographics and a growing aging population? How will those changes impact your community, and how do you do business as a social service agency in California? Join us to hear about the National Aging Network and learn from the National Association of Area Agencies on Aging, the leading voice on aging issues for area agencies on aging and a champion for Title VI Native American aging programs.

- Moderator: **Jim Rydingsword**, *Director, Mariposa County Human Services Department*
- **Sandy Markwood**, *Chief Executive Officer, National Association of Area Agencies on Aging*

2:30 PM — 2:45 PM

Break.....3rd Floor East Lobby

2:45 PM — 4:00 PM

General Session.....Ballroom 306/307/308

■ Featured Speaker:

- **Melissa Harris-Perry**, *Professor of Political Science, Tulane University, Author of Sister Citizen: Shame, Stereotypes, and Black Women in America*

Race, Poverty and Insecurity in Today’s Political Agenda

The data are clear: the pain of the economic downturn is being felt far more acutely by some Americans than by others. And the poor, who are getting poorer each year, are blamed for their own circumstances, even as major corporations pay more to CEOs than they contribute in taxes. Melissa Harris-Perry will discuss how we can craft a political agenda that makes alleviating poverty our top priority and explain why doing so is necessary to save the American dream.

4:00 PM — 4:30 PM

General Session.....Ballroom 306/307/308

■ Wrap-Up and Closing

SPEAKER BIOGRAPHIES

Katie Albright is Executive Director of the San Francisco Child Abuse Prevention Center. She joined the Center from the San Francisco Education Fund, a nonprofit organization seeking to support quality teaching and learning in public schools, where she served as the policy director. Prior to the Ed Fund, Albright served as co-director of policy and outreach at Preschool California, a statewide, multi-year advocacy campaign to achieve voluntary preschool for all of California's 3- and 4-year-olds. Albright also served as deputy city attorney for the Office of the City Attorney in San Francisco for seven years. In addition, she was an associate at Latham & Watkins, LLP in Los Angeles, and a law clerk for the United States District Court in Maryland. She co-founded and taught in the Kayole-Gitau Nursery School and Community Center in Nairobi, Kenya. Albright graduated with honors from Georgetown University Law Center and received her Bachelor of Arts from Williams College.

Armida Barrera is a resident of South Los Angeles and a parent of two children who currently attend a Synergy Academies school. One of her sons attends Synergy Kinetic Academy middle school, and one of her daughters is entering Synergy Quantum Academy high school. She has been an actively involved parent with Synergy Academies since 2004.

Jason Britt is Director of Human Services for Tulare County. Britt joined the county as an eligibility worker in 1994, and since has held a variety of positions including deputy director and public guardian/conservator. During his tenure, he has successfully led efforts in his county in the re-design of business processes for CalWIN, quality control, and document imaging systems, including establishment of a client contact center. He serves as the CWDA CalFresh committee chair, vice chair for the CalWIN Consortium Board of Directors, and is a board member with the Tulare County Workforce Investment Department. Britt has a Bachelor of Science in Liberal Arts, and a Master of Science in Leadership from South University.

Paul Buddenhagen is Administrator of the One-Stop Career Centers and Service Integration Program for Contra Costa County. The multi-disciplinary collaboration includes three county departments, two school districts, community-based organizations, and neighborhood residents. The Service Integration Program's two Family Service Centers were designed to take an innovative approach to helping low-income families involved in multiple systems. Buddenhagen graduated from the University of California, Berkeley, School of Social Welfare, and immediately began working for the Contra Costa County Employment and Human Services Department. During his time with the county, he has also served as the county/nonprofit liaison for agencies that received county child abuse prevention funding.

Dr. Nadine J. Burke, M.D., M.P.H., F.A.A.P., AE-C, is the founding physician and Medical Director of the Bayview Child Health Center, a community-based satellite clinic of California Pacific Medical Center. Despite its location in San Francisco, which has one of the highest physician-per-capita ratios in the United States, Bayview is federally designated as a medically underserved area. Dr. Burke's areas of interest are in health disparities, child trauma, asthma and nutrition. She received her Bachelor of Arts from the University of California, Berkeley. She is a graduate of the University of California, Davis, School of Medicine, and holds a master's degree in public health from Harvard School of Public Health. She completed her internship and residency in pediatrics at the Lucile Salter Packard Children's Hospital at Stanford. Dr. Burke is board certified in pediatrics. She was recently featured in the film *Nourish*, along with prominent food activists Michael Pollan and Alice Waters, discussing the importance of food and community.

Oscar Chavez is Executive Director of Community Action Partnership of Sonoma County and a Commissioner with First 5 Sonoma County. He moved to Sonoma County after many years with the Kern County Community Action Agency where he held several different positions, including director of public relations and marketing, director of business support services, and interim executive director. Prior to joining the Partnership, Chavez directed multiple pilot projects and initiatives for the Office of Economic and Community Development at Oxnard College and was the assistant to the Dean of Instruction and Innovation. He is also a member of the California Nevada Community Action Partnership, the Sonoma County Innovation Council, Sonoma County Health Action Council, founding member of the Sonoma County Coalition for Latino Civic Engagement, and was recently chosen as one of the North Bay's 40 Under 40 leaders by the North Bay Business Journal. He holds a Bachelors of Arts from California State University, Bakersfield in political science.

Josè Cisneros is Treasurer for the City and County of San Francisco, a position he was appointed to in 2004 by former Mayor Gavin Newsom. He was elected to a full term in November 2005. That same year, Cisneros led the implementation of the Working Families Credit Program, an innovative public/private partnership providing a tax credit to qualified San Francisco families. More than 9,500 of the city's lowest-income working families have received more than \$2 million from the program, which provides a match to the federal Earned Income Tax Credit. Prior to his appointment, he served as deputy general manager for the San Francisco Municipal Transportation Agency. Before working at MUNI, he served as a member of the MTA Board of Directors. He also previously worked for IBM Corporation and Lotus Development Corporation as a senior international product manager. Cisneros received his Bachelor of Science from Sloan School of Management at the Massachusetts Institute of Technology, and studied for an MBA at Boston University.

Michelle Clark is a Social Worker Supervisor with the Tuolumne County Human Services Agency. She currently supervises the Foster Care Licensing Program, Relative/Non-Related Extended Family Member Assessments, Independent Living Program, In-Home Supportive Services Program, Transitional Housing Placement-Plus Program, and Tuolumne County's HOPE House – Housing and Opportunities Program for Emancipated Foster Youth. Clark started with the county in 2001 as a social worker, working up the ranks to be promoted to a supervisor in 2006. Clark graduated from California State University, Chico with a Bachelor of Arts in psychology.

Sandra DeLaTorre is a resident of South Los Angeles, and parent of three children who currently attend a Synergy Academies school. She has a son and a daughter attending Synergy Kinetic Academy middle school, and she has a daughter attending Synergy Charter Academy elementary school. She has been an actively involved parent with Synergy Academies since 2005.

Diana Dooley is Secretary of the California Health and Human Services Agency, a position she was appointed to by Governor Jerry Brown. Dooley is a member of the California Health Benefit Exchange Board. She also serves as a member or ex-officio member of numerous other boards and commissions, including: First 5 Commission, Cal eConnect Board, Olmstead Advisory Committee, Alzheimer's Disease and Related Disorders Advisory Committee, Child Welfare Council, Managed Risk Medical Insurance Board, and the California Workforce Investment Board. Prior to leading the agency, Dooley was president and chief executive officer of the California Children's Hospital Association. Dooley began her professional career as an analyst at the State Personnel Board. In 1975, she was appointed to the staff of Governor Jerry Brown for whom she served as legislative director and special assistant until the end of his term in 1983. She earned her bachelor's degree in social science from California State University, Fresno, and her law degree from San Joaquin College of Law.

Linda Downey is the Juvenile Unit Division Manager for Tuolumne County Probation Department. She started with Tuolumne County in 1995, holding various positions, including eligibility worker, child welfare services social worker, deputy probation officer, social services supervisor, and child welfare services program manager. In 1997, Downey developed the county's Independent Living Program. She was instrumental in working with the County Administrator's Office to submit a grant proposal through the Emergency Housing Assistance Program Capital Development for the construction of a transitional home for emancipated foster youth.

Elaine Emery, R.D., is Program Manager for Nutrition Services with the Stanislaus County Health Services Agency, where she recently marked her 20-year anniversary. She oversees the WIC program, which has a monthly caseload of more than 22,000 clients. She has been very active in the California WIC Association and most currently a board member for the National WIC Association, representing the local WIC agencies from the Western region states. She has been very excited to work closely with her counterparts in the social services agency, particularly with the new Community Nutrition Expansion Project for this new fiscal year, which will bring nutrition education to CalFresh participants in Stanislaus County.

Terri Fields Hosler, M.P.H., R.D., is the Deputy Director for Shasta County Public Health, overseeing all programmatic areas including Healthy Communities, Healthy and Safe Families, Communicable Disease and Disaster Planning, and the Children's Health Services Divisions. She previously served as the program manager for the Chronic Disease and Injury Prevention Division. In this role, she created a vision for a collaborative countywide approach to addressing childhood obesity called Healthy Shasta, and helped to launch this community partnership in 2005. She has more than 30 years of experience as a registered dietitian, and 20 years of experience in public health prevention programs. Her current professional passion is focused on collaborative efforts to address the social determinants of health through systems work and policy development, especially around obesity prevention and the promotion of educational attainment and career readiness in the Shasta County community.

Lee Ann Kelly is Acting Bureau Chief of the California Department of Social Services' Office of Child Abuse Prevention. The Office of Child Abuse Prevention administers federal grants, contracts, and state projects and programs designed to promote best practices and innovative approaches to child abuse prevention, intervention and treatment. Some of these projects include the California Evidence Based Clearinghouse for Child Welfare, Linkages, the Supporting Father Involvement Intervention and Evaluation, and the Family Development Matrix. Prior to coming to OCAP, Kelly was in the Child Welfare Policy and Program Development Bureau, where her responsibilities included oversight of such areas as Emergency Response, Family Maintenance, the Standardized Safety Assessment System, Indian Child Welfare Act projects and Differential Response, among others. She has more than 25 years experience in human services programs.

Barbara LaHaie is Assistant Director with the Humboldt County Department of Health and Human Services. She is responsible for the oversight of Mental Health, Public Health and Children and Family Services Branches. In addition, she provides direction to the Integrated Services Unit including research and evaluation, training, education and supervision, and the Office of Client and Cultural Diversity. She is the co-chair for the Humboldt Housing and Homeless Coalition – the county's identified HUD Continuum of Care – and a member of the Workforce Investment Board. Prior to her employment at Humboldt County, she was a director at a nonprofit agency providing foster care, mental health services, residential care, transitional housing, family preservation, kinship support services, and day treatment programs.

Judy Langford is a Senior Fellow at Center for the Study of Social Policy. Her work for CSSP includes field research, policy and program analysis, and technical assistance to foundations, governmental agencies, and private organizations on the development and implementation of family supportive practices and policies. She is currently the national project director for Strengthening Families, a multidisciplinary approach to preventing child abuse and promoting healthy child development that is now used in more than 25 states. Langford is also part of the leadership team for the federal Quality Improvement Center on Early Childhood. She is the former executive director of the Family Resource Coalition, and previously headed the Ounce of Prevention Fund in Chicago. She has been an advisor to numerous foundations, including the Robert Wood Johnson Foundation, the Ewing Marion Kauffman Foundation, and Casey Family Programs.

Alison Lehman is Social Services Director for Nevada County Health and Human Services Agency, where she is responsible for delivery of public assistance, workforce development, veterans, children and adult welfare programs. She has been with Nevada County since 2001, and has held several leadership positions including acting assistant county executive officer and acting public health director. Lehman serves on several local nonprofit boards including Nevada County Economic Resource Council, Nevada County Arts, and Nevada County Digital Media Center. Prior to joining Nevada County, she was the executive director of a children's nonprofit in Yolo County that provides advocacy services for youth in the juvenile justice system. With a Bachelor of Arts in political science from University of California, Berkeley, Lehman has more than 17 years of experience in government and community nonprofit settings.

Will Lightbourne is Director of the California Department of Social Services, which he was appointed to by Governor Jerry Brown in April 2011. Prior to that, he served as director of the Santa Clara County Social Services Agency for more than 10 years, and was executive director of the Human Services Agency of San Francisco from 1996 to 2000. Previously, he was the director of the Santa Cruz County Human Services Agency. He served as CWDA's 2004 president, and headed up several of its committees. Before his role in the public human services field, Lightbourne served as general director of Catholic Charities of the Archdiocese of San Francisco, one of the oldest and largest private human services organizations in the Bay Area.

Senator Carol Liu represents the State Legislature's 21 Senate District, which includes the cities of Burbank, Glendale, Pasadena, La Cañada Flintridge, San Gabriel, Temple City and other Los Angeles communities. Born in Berkeley and raised in Oakland, Senator Liu attended public schools and graduated from San Jose State College. She earned a teaching credential and a credential in education administration from the University of California, Berkeley, School of Education. She was a teacher in Richmond public schools for 14 years, and also worked as a school administrator. After relocating to Southern California, Liu became involved in key community volunteer and civic leader posts. She served as a PTA president and as president of the Pasadena City College Foundation Board. In 1992, Liu was elected to the La Cañada Flintridge City Council, serving on the council for eight years, including two terms as mayor. In 2000, she was elected to the State Assembly to represent the 44th District and served three terms. After being termed-out of her service in the State Assembly in 2006, she resumed teaching and community service activities. She was elected to the State Senate in 2008. She has been awarded Legislator of the Year honors by several organizations.

Michelle Love, LCSW, is currently the interim Assistant Agency Director for the Department of Children and Family Services in Alameda County. She previously was responsible for the Department's Prevention & Intake Programs, which include: the Alternative Response System, Emergency Response Program, Dependency Investigations, and Family Maintenance. Prior to her promotion, Love was the department's senior lead for its disproportionality work. She was also responsible for the implementation of Team Decision Making in Alameda County, and has served as a trainer for Team Decision Making facilitators. She has 15 years of experience in the child welfare system in a variety of roles.

Sandy Markwood is Chief Executive Officer of the National Association of Area Agencies on Aging (n4a), and has more than 30 years experience in the development and delivery of aging, health, human services, housing, and transportation programs in counties and cities across the nation. Prior to coming to n4a in 2002, she served as the deputy director of county services at the National Association of Counties where she took a lead role in research, training, conference planning, program development, technical assistance, and grants management. In her role, Markwood leads n4a's fundraising efforts and engages corporate sponsors to support critical initiatives, including an aging awards/best practices program and the Leadership Institute for Area Agency on Aging staff. Externally, she forms strategic partnerships with federal agencies and organizations in aging, human services, and health care arenas to enhance the role and recognition of area agencies on aging and Title VI programs.

Erwin "Mac" McEwen is the Former Acting Director of the Illinois Department of Children and Family Services. Prior to his appointment, McEwen served as deputy director of the agency's Division of Monitoring and Quality Assurance since 2003. Before his appointment in state government, McEwen served as child welfare administrator at Lakeside Community Committee, where he oversaw four core child welfare programs. McEwen has also served as a member of the Illinois Statewide Foster Parent Advisory Council, the Illinois Child Care Association Board of Directors, the Child Welfare Advisory Committee on Performance-Based Contracting, and the African American Family Commission's Monitoring and Oversight Committee. McEwen is a recipient of the University of Chicago's Evelyn Harris Ginsburg Memorial Prize and Elinor Nims Brink Fellowship, and the We Care Role Model Award from the Chicago Police Department and Board of Education. He holds a master's degree from the University of Chicago, School of Social Service Administration, with a clinical concentration in family systems, and a bachelor's degree in economics from Illinois State University.

Karen McGettigan is a Staff Services Analyst II with the Tuolumne County Human Services Agency. She began her career as a high school English teacher in Stockton before moving to Sonoma and joining the Tuolumne County Human Services Agency in 2005. She started as a social worker I for Child Welfare Services and was assigned to the Emergency Response Unit. She was later promoted to social worker II and social worker III. She graduated from University of the Pacific with a Bachelor of Arts in English and communication. She also earned a Master of Arts in composition and rhetoric from California State University, Stanislaus.

Frank Mecca, M.P.A., is Executive Director of the County Welfare Directors Association of California. He has served as the Executive Director for the past 20 years, during which he has helped establish CWDA as a leading advocacy and policy organization in the field of public human services. Prior to joining CWDA, Mecca served as a fiscal and policy analyst for the Legislative Analyst's Office, where he had oversight responsibility for most child welfare programs, including Child Welfare Services, Foster Care and Adoptions. He holds a master's degree in public affairs with a concentration in social welfare policy from the Lyndon B. Johnson School of Public Affairs at the University of Texas, Austin. He earned his undergraduate degree in government and economics from Franklin and Marshall College in Lancaster, PA.

Lynn Nolte is Program Manager with Tuolumne County Human Services Agency's Transitional Youth Initiatives. She has more than 21 years of experience in social services programs and collaboration with community resources, including Tuolumne County schools, Columbia Community College, Center for a Non Violent Community, Amador-Tuolumne Community Action Agency, Tuolumne County Probation Department, Mother Lode Job Training Agency, Infant Child Enrichment Services, Tuolumne County Behavioral Health, Tuolumne County Sheriff's Department, Interfaith and Catholic Charities. Over the years, Nolte has held various positions, including eligibility worker, employment and training worker, employment and training supervisor, and program manager.

Rourke O'Brien is a Research Fellow with the New American Foundation's Asset Building Program, where he concentrates on policies aimed at promoting economic self-sufficiency for low- and moderate-income families. O'Brien's current research projects include analyzing the economic behavior of low-income families, specifically to determine how public assistance eligibility and informal lending networks influence savings. He also contributes to the program's policy work on reforming and expanding the use of 529 college savings plans and designing saving and behavior incentives for low-income families. O'Brien holds a Bachelor of Arts in social studies from Harvard University, and is currently a doctoral student in sociology and social policy at Princeton University where he is a National Science Foundation Graduate Research Fellow. His writings on issues related to savings, asset building, and economic independence have appeared in *The New York Times*, *The Washington Post*, *Los Angeles Times*, *The Chronicle of Higher Education*, and *The Christian Science Monitor*.

Meg Palisoc is Co-Founder, Teacher, and Chief Executive Officer of Synergy Charter Academy. As an administrator at the University of Southern California, Palisoc noticed that college students who came from inner-city public K-12 schools were often not as academically prepared as their peers. This prompted her to transition from higher education and become an elementary school teacher. As a teacher, she saw that inner-city schools were not improving quickly enough. She went on to co-found Synergy Charter Academy and Synergy Kinetic Academy to more rapidly create educational equity for all students. The vision of Synergy Academies is that students will meet or exceed the California Content Standards and be prepared to take college-preparatory classes in secondary school, and eventually attend a four-year university of their choice. Synergy Charter Academy was the highest-performing, fully implemented K-5 school in South Los Angeles in 2006-2010. Synergy has won numerous prestigious awards through the years, most recently a 2010 National Blue Ribbon Award, the highest honor that an American public school can earn.

Randy Palisoc is Co-Founder, Teacher, and Chief Achievement Officer of Synergy Charter Academy. He began teaching in 1997 in a struggling inner-city public school. Even though the majority of the students at his school were performing significantly below grade level, he saw their potential and believed that didn't need to be the case. In order to create an environment where students could reach their full potential, Palisoc co-founded Synergy Charter Academy and Synergy Kinetic Academy in South Central Los Angeles. The vision of Synergy Academies is that students will meet or exceed the California Content Standards and be prepared to take college-preparatory classes in secondary school, and eventually attend a four-year university of their choice. Synergy Charter Academy was the highest-performing, fully implemented K-5 school in South Los Angeles in 2006-2010. Synergy has won numerous prestigious awards through the years, most recently a 2010 National Blue Ribbon Award, the highest honor that an American public school can earn.

Tim Reese is Executive Director of the California/Nevada Community Action Partnership (Cal/Neva), a state association representing community action agencies. He has spent his entire career in human services. He started out as a special education teacher at Fairview Developmental Center, then became a counselor for disabled students at Coastline Community College, transitioned into brain injury rehabilitation at Community and Mercy hospitals, and was executive director of a six-county HIV/AIDS services provider. He was the first man to lead the largest shelter-based domestic violence program in California, and directed a three-county food bank. In his spare time, Reese has taught nonprofit management in the American Humanics Program at the California State University, Fresno, Craig School of Business. Since joining Cal/Neva in 2005, Reese has become known as a leader in community action state association work nationally. Born in San Diego, Reese's formative years were spent in Kenya and Uganda, East Africa. He graduated from the American International School of Kabul, in Kabul, Afghanistan. He is a graduate of Vanguard University and Pepperdine University.

Charlene Reid is Director of the Tehama County Department of Social Services. She graduated with a master's degree in social work from California State University, Fresno. For more than 28 years, she has committed herself to serving children and families as a social worker. She has held numerous roles as supervisor, manager, trainer and agency director. Critical to her success in public social services is her ability to provide direction in collaborative, team driven, and partnership processes. She is respected as a leader in change management and innovation both locally and statewide. Reid has dedicated her career to improving systems, services, and programs for the most vulnerable and disenfranchised populations. She is a member of the CWDA Executive Committee.

Trent Rhorer has served as Executive Director of the Human Services Agency of San Francisco since 2000, when he was appointed by former Mayor Willie Brown. The agency administers the city's public social service programs for low-income families, children, single adults, the elderly and disabled adults, annually serving more than 125,000 San Francisco residents. Prior to this appointment, Rhorer served as the executive director's chief of staff and was the chief policy analyst for the department, where he has worked since 1996. For four years, Rhorer served as former Mayor Gavin Newsom's point person on homelessness as well as chair of the Mayor's Interagency Homeless Cabinet. He has also served as the CWDA 2006 president, chair of the San Francisco First Source Hiring Administration, and a member of the Workforce Investment Board of San Francisco. He has a bachelor's degree in political science from University of California, Los Angeles, and a master's degree in public policy from the Kennedy School of Government at Harvard University.

Michael Riley is Director of the Orange County Social Services Agency, where he's spent more than 14 years. Prior to becoming director, he was the chief deputy director of the agency. He also served as director of the Children and Family Services Division for 10 years. Riley also has worked with troubled families and children in crisis at Father Flanagan's Boy's Home in Nebraska and as director of Boy's Town of Southern California. Riley has a doctorate in educational psychology and a Master of Science in behavior disorders and learning disabilities. He was awarded Outstanding Teacher of the Year by the Nebraska Council of Children with Behavior Disorders. He is a Vietnam combat veteran of the United States Army.

Elliott Robinson is Director of Social and Employment Services for Monterey County where he has been since 2001. The department is one of the largest departments in the county with a budget of \$170 million and 835 employees. More than 20 percent of the Monterey County community is served by the department every month. Robinson is also president of CWDA, a past chair of the American Public Human Services Association's National Council of Local Human Services Administrators, chair of the First 5 Monterey County Commission, and a member of the Monterey County Children's Council. Prior to coming to Monterey County, Robinson was the finance director for the Alameda County Social Services Agency. He earned his master's degree in social welfare from the University of California, Berkeley, and his Bachelor of Arts in psychology from Stanford University.

Jim Rydingsword is Director of the Mariposa County Human Services Department and responsible for administration and service delivery programs for a wide range of human service programs in the community. His background in executive management of human services program since 1981 combined with his experience in introducing complex information systems to small and large organizations provides the necessary leadership needed to work with both governmental and nonprofit organizations. His customer relation skills were developed as a consultant with Paradigm Innovations, as a member of National Boards of Directors in Human Services, and through advocacy on human service issues at both the state and federal levels. Rydingsword is a member of the CWDA Executive Committee.

Herb Schultz is Region IX Director for the U.S. Department of Health and Human Services. Previously, he served as senior advisor to Governor Arnold Schwarzenegger and director of the California Recovery Task Force. In this role, he was responsible for the oversight and implementation of the American Recovery and Reinvestment Act of 2009. As senior advisor to the former governor from 2008-2010, he represented the governor on major domestic policy issues, which included serving as a principal advisor on health care reform. He also served as the senior health policy advisor to Governor Schwarzenegger during California's 2006-2008 state debate on comprehensive health care reform. From 2005-2006, he served as vice president of government programs for McKesson Health Solutions, where he oversaw the company's disease management and nurse advice programs for Medicaid and Medicare beneficiaries. Schultz received his Bachelor of Arts in political science and international studies from American University in Washington, D.C., and has a master's degree in public policy from Georgetown University.

Gina Sessions is Acting Director with the Santa Clara County Social Services Agency. Prior to this role, Sessions was the deputy director of operations, where she served on the Juvenile Justice Systems Collaborative Prevention and Programs Work Group. She came to the agency in 2006, and has worked in the Santa Clara County community since 1985. She spent the first 20 years of her career in the mental health field, and has experience in the private, nonprofit and government fields. Sessions has held a variety of managerial and leadership positions, and directed an array of programs, including residential, foster family services, school-based services and clinic-based services. She earned a doctorate in clinical psychology from the California School of Professional Psychology.

Rebecca Smith is the California representative for the National Employment Law Project, which she joined in 2000, after nearly 20 years advocating for migrant farm workers in the state of Washington. At NELP, she has worked with state advocates to modernize state unemployment insurance programs, promoting reforms to fill the gaps in the program denying benefits to women and families. She has also worked to apply international human rights laws to help protect immigrant workers in the United States, and with immigrant workers organizing groups to enforce U.S. labor laws. She has testified before Congress and several state legislatures, and published on these issues. In 2003, she received the United Farm Workers of America's Aztec Eagle Award, in addition to the Golden Door Award from Northwest Immigrants' Rights Project, and special recognition by the foreign minister of Mexico for her work on behalf of undocumented workers before the Interamerican Court of Human Rights. She earned her law degree from the University of Washington Law School and undergraduate degrees from Washington State University and University of Washington.

Tse Ming Tam is Vice President for Community Investment with the United Way of the Bay Area, which he joined in 2006. Tam manages the Financial Stability Partnership portfolio which focuses on helping households reduce debts, build income, and build and protect assets. Prior to joining United Way, Tam was a program director at the National Economic Development and Law Center. While there, he helped transform the organization's sector demonstration project into a field of practice, with more than 400 practitioners and investment by the U.S. Department of Labor. He also helped create the National Network of Sector Partners, a national membership-based organization and project of the Insight Center that provides information and resources. Prior to joining the Insight Center, Tam served as the acting director for Chinese for Affirmative Action, a nonprofit civil rights advocacy organization promoting equal access to housing, education, employment, contracting and public services. During his tenure as acting director, the organization received President Bill Clinton's Community Excellence Award.

Simone A. Taylor is Director of Family Services of Redwood Community Action Agency, and has more than 30 years experience developing and managing programs that assist homeless families and those surviving domestic violence. In addition, she has worked as an elementary school guidance counselor to implement preventive mental health programs and services to children, youth, parents, and teachers.

Joe Valentine is Director of Contra Costa County's Employment and Human Services Department. This position is responsible for providing oversight to Children's Services Programs, Income Support Services, Employment and Training Services, Medical Assistance, CalFresh, Aging and Adult Services, Head Start, Community Action Programs, and Domestic Violence Prevention Services. Valentine has more than 30 years experience in managing public human service programs at the city, county, and state level. He received a master's degree in social work from the University of Washington, and spent most of his career in the state of Washington. He has also been an adjunct instructor for Western Washington University and San Francisco State University, and has taught a wide variety of public policy and management courses.

Natalie Walter is Department Administrator for the San Luis Obispo County Department of Social Services, where she has been employed since 2002. Previously she was a financial manager in San Mateo County and worked for both the Health Services and Human Services Departments. Walter graduated from San Francisco State with a bachelor's degree in social work and began her career in social services immediately following. She earned her master's degree in public administration from Notre Dame University. She serves on several committees in San Luis Obispo County, including the Health Care Committee, the Employee University Advisory Committee, and the Civil Service Rules Committee. She has been involved with San Luis Obispo County's efforts to end poverty and was instrumental in hosting the first Opportunity Conference in California. Walter has been involved in hosting the county's poverty symposium, and she recently attended Dr. Donna Beegle's Poverty Institute, a hands-on, two-day poverty institute for educators, health, justice and social service professionals, and community members who want to better understand poverty and to gain tools for making a difference. Beegle's institute and Opportunity Conference were featured at the 2010 CWDA Symposium.

Jo Weber is Director of Sonoma County Human Services Department. She has spent 30 years in social services in California, working for Riverside County and also at the state level. Prior to becoming Sonoma County's director, Weber served as assistant director for Sonoma and Riverside County Departments of Human Services. She has also served in various positions with the California Department of Social Services, providing support to county human services operations through the development of research, budget analysis, policy development and oversight, and legislative advocacy. She serves on a variety of county, statewide and national boards, including commissioner with Sonoma County's First Five Commission, United Way, and a member of the Santa Rosa Mayor's Gang Prevention Task Force. She is vice president of CWDA and a member of the County Services Medical Program Governing Board. Nationally, Weber is president of the National Association of County Human Services Administrators. She holds a Master of Arts in marriage and family therapy.

Anne Wilson is Chief Executive Officer of United Way of the Bay Area, which she joined in 1980. She became the organization's first female CEO in 2000. Under her leadership, United Way of the Bay Area has transformed into a community-impact organization that brings together resources and people to create pathways out of poverty. Wilson has championed several programs, including SparkPoint Centers, which work with families and individuals to create personal financial plans that help achieve their goals; Earn It! Keep It! Save It! Bay Area, which last year helped 47,000 hardworking families claim \$47.4 million in valuable tax credits and access asset-building resources; and 2-1-1, the three-digit phone number that connects people with community services for every day needs and in times of disaster. She has a Master of Social Welfare from the University of California, Berkeley, and a Bachelor of Science from Syracuse University.

Diane Woloshin is Director of Nutrition Services for the Alameda County Health Department. She has more than 25 years of public health and advocacy experience acting as manager of numerous large-scale public health programs and special projects. She has worked in various county health department and nonprofit agencies and most recently was the deputy director of the California WIC Association. Woloshin is a registered dietitian and received her Bachelor of Science from the University of Wisconsin, Madison, and a Master of Science in health care administration from California State University at Long Beach. She is passionate about health and nutrition and promoting healthy communities, and is a member of the Oakland Food Policy Council and the HOPE collaborative.

Sacramento Convention Center

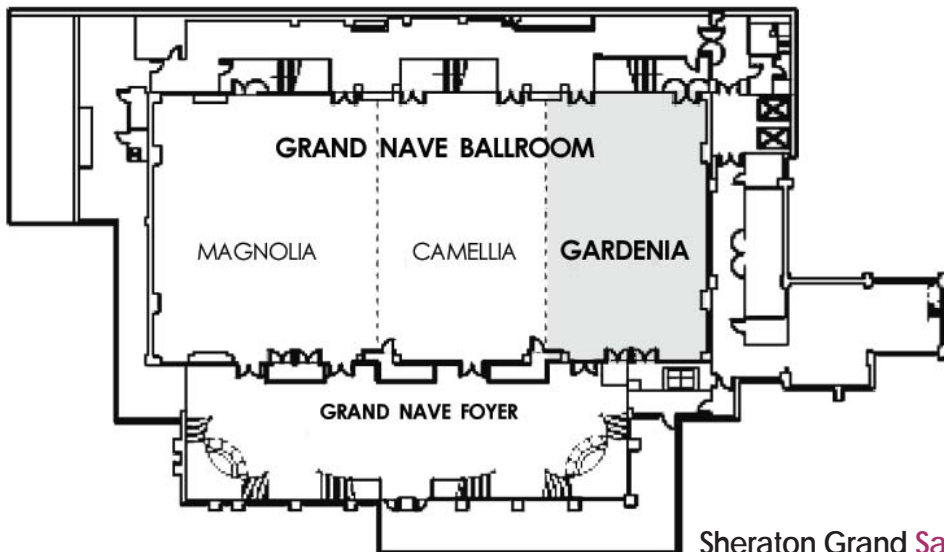
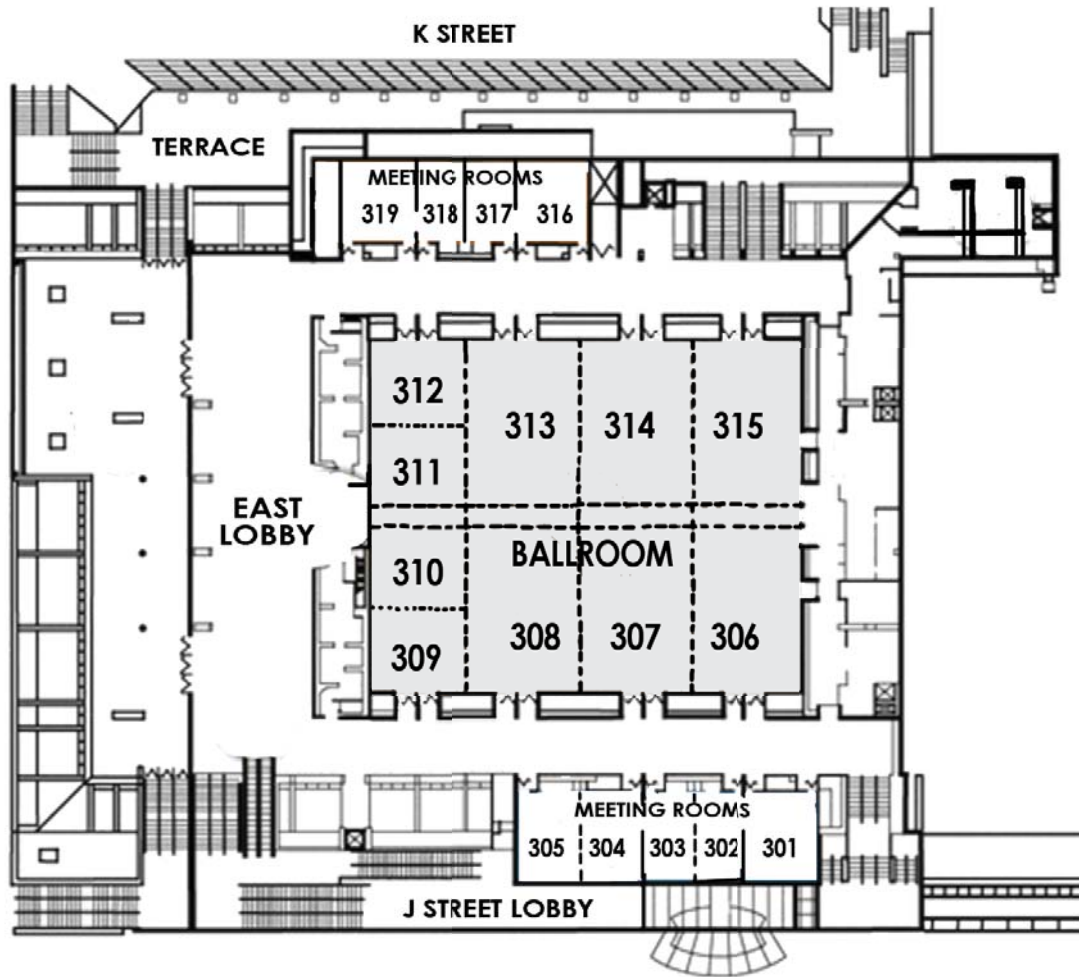

Sheraton Grand Sacramento



PLATINUM SPONSORS:

Accenture
HP Enterprise Services
InTelegy Corporation
Northwoods

GOLD SPONSORS:

Deloitte
CGI
IBM

Special THANKS to our generous Sponsors

** CWDA wishes to acknowledge the staff of The Center for Human Services, UC Davis Extension, University of California, and Merced County Human Services Agency for their valuable support and assistance in organizing this Symposium.*